

MANAGEMENT UNIT 25: McCarthy - Nizina River

Background

This management unit consists of state-owned land north of the Nizina River and east and south of McCarthy. The land is entirely within the Wrangell - St. Elias National Park and Preserve. The area is primarily state owned with some University and private land interspersed. The area is used by local residents for hunting, trapping, and firewood gathering. Access is provided by two bush airstrips, one an unmaintained public airstrip near McCarthy and the other a private strip near the Nizina River. Overland access requires crossing McCarthy Creek. Summer access is difficult because there are no bridges across McCarthy Creek and the water is usually too high to ford easily and safely. An old road traverses the entire tract, but bridges across McCarthy Creek and the Nizina River have been destroyed in floods.

Management Intent

This is a unique parcel of state land because of its location within the Wrangell - St. Elias National Park and Preserve. This land will be kept in public ownership and managed for multiple use. The emphasis will be on uses which complement the recreational values of the National Park. The state currently does not plan to develop recreation facilities (such as campgrounds) on state land. Leases and permits for commercial and noncommercial recreation activities may be allowed if consistent with other guidelines in this plan and applicable regulations. Leases for nonrecreational or nonpark related activities are prohibited. The unit will be opened to mineral entry (it was closed pending land exchange or sale). Because forest resources are limited, they will be managed primarily for personal use harvest.

Management Guidelines

Public Notification - McCarthy Residents. DNR will notify residents of the McCarthy area and provide for their input before issuing any leases on state land in this unit. Notification should include notice via radio or posting at prominent places in the community or both.

Land within Wrangell - St. Elias National Park. DNR will notify the Superintendent of the Wrangell - St. Elias National Park and Preserve of any requests for permits, leases, or other authorizations for use of state lands that may significantly impact the national park and preserve.

The complete set of management guidelines is presented in Chapter 2. Any of the guidelines could apply to uses within this management unit; however, guidelines that are most likely to apply are:

- Fish and wildlife habitat
- Forestry
- Recreation, cultural, and scenic resources
- Transportation
- Public access

LAND USE DESIGNATION SUMMARY

MANAGEMENT UNIT: 25 - McCarthy-Nizina Rivers

SUBUNIT	LAND OWNERSHIP (GENERALIZED)	LAND USE DESIGNATIONS				PROHIBITED SURFACE USE(S)*	COMMENTS
		SURFACE		SUBSURFACE			
		PRIMARY USE(S)	SECONDARY USE(S)	LOCATABLE MINERALS	LEASEABLE MINERALS		
25A	State	Public recreation Wildlife habitat	Forestry	Open to mineral entry	Available for leasing	Land offerings Remote cabins	
25B	State	Forestry Public recreation Wildlife habitat		Open to mineral entry	Available for leasing	Land offerings Remote cabins	

* Other uses such as material sales, land leases, or permits, that are not specifically prohibited may be allowed. Such uses will be allowed if consistent with the management intent statement, the management guidelines of this unit, and the relevant management guidelines listed in Chapter 2.

RESOURCE INFORMATION SUMMARY

Management Unit 25 - McCarthy - Nizina Rivers

RESOURCE	SUBUNIT	
	25A	25B
Fish	salmon - s/r steelhead - s	none docum.
Forestry	moderate conif. and decid.	moderate conif. and decid.
Historic-Cultural	prehistoric remains and mining remains	prehistoric remains and mining remains
Minerals	outside of known mineral terranes	low
Oil and Gas	unknown	unknown
Recreation	high for river floating; scenic, inside national park	high; inside national park; scenic
Sand and Gravel	none ident.	existing site
Settlement Suitability	low	low to moderate
Transportation	old road (no bridges)	airstrip, old road (no bridges)
Wildlife	B-2 habitat	B-2 habitat

Minerals: Most mineralized lands are north and east of state lands.

Important trails: Subunits 25A and 25B - old road is used as a trail, but has no bridges at McCarthy Creek and Nizina River. Crossing both streams when not frozen is hazardous at best.

For definitions of ratings, see glossary. For more detailed information on any resources, see resource elements published under separate cover.

MANAGEMENT UNIT 25

McCarthy/Nizina River

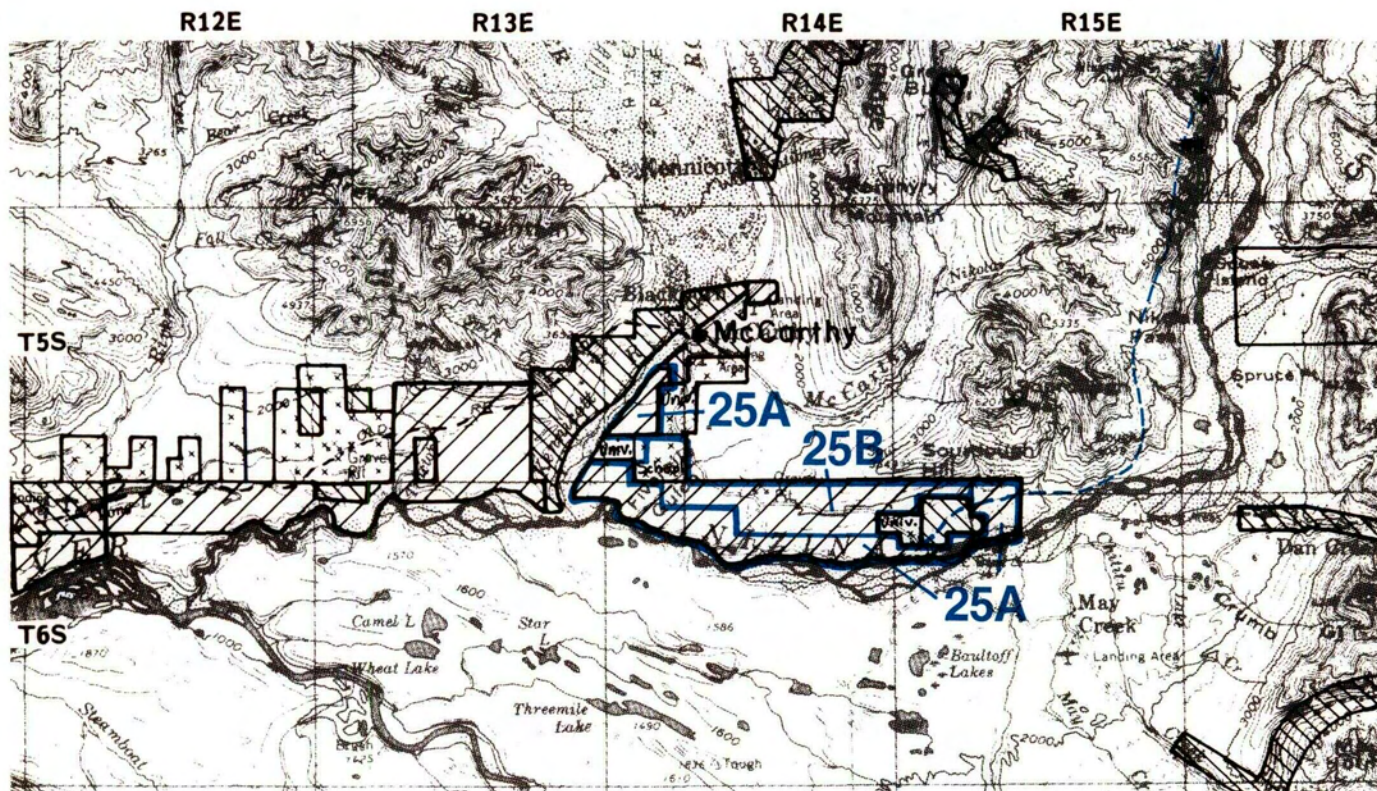



Location Map



Map scale:
1:250,000

U.S.G.S. Quad:
McCarthy

-  State Owned
-  State Selected
-  Native/Private Owned
-  Native Selected
-  Federal
-  Trails on public lands

Map shows approximate location of easements to state land and major trails across state land. Portions of trails may cross private lands. See appendix D.

ACE 6329545